

RD7 Series

Miniature Cross Slide Type

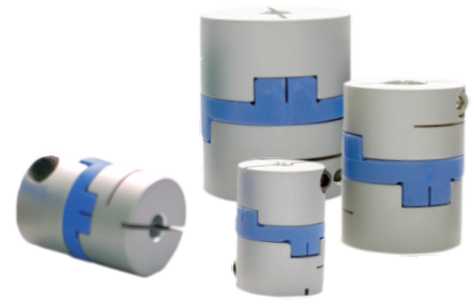

Parameters

Model	Rated Torque (N.m)	Max Torque (N.m)	Max Rotational Speed(min-1)	Moment of Inertia (kg.m ²)	Static Torsional Stiffness(N.m/rad)	Parallel Misalignment (mm)	Angular Misalignment(°)	Weight(g)
RD7-16S	0.7	1.4	9500	3.2x10 ⁻⁷	31	1.0	3	7
RD7-20S	1.2	2.4	7600	1.0x10 ⁻⁶	60	1.5	3	14
RD7-25S	2	4	6100	3.0x10 ⁻⁶	140	2.0	3	27
RD7-32S	4.5	9	4800	9.5x10 ⁻⁶	280	2.5	3	50
RD7-40S	9	18	3800	2.3x10 ⁻⁵	540	3.0	3	80
RD7-50S	18	36	3100	6.7x10 ⁻⁵	820	3.5	3	150
RD7-16C	0.7	1.4	9500	5.8x10 ⁻⁷	31	1.0	3	12
RD7-20C	1.2	2.4	7600	1.5x10 ⁻⁶	60	1.5	3	19
RD7-25C	2	4	6100	4.4x10 ⁻⁶	140	2.0	3	36
RD7-32C	4.5	9	4800	1.4x10 ⁻⁵	280	2.5	3	69
RD7-40C	9	18	3800	4.1x10 ⁻⁵	540	3.0	3	130
RD7-50C	18	36	3100	1.2x10 ⁻⁴	820	3.5	3	230

Dimensions

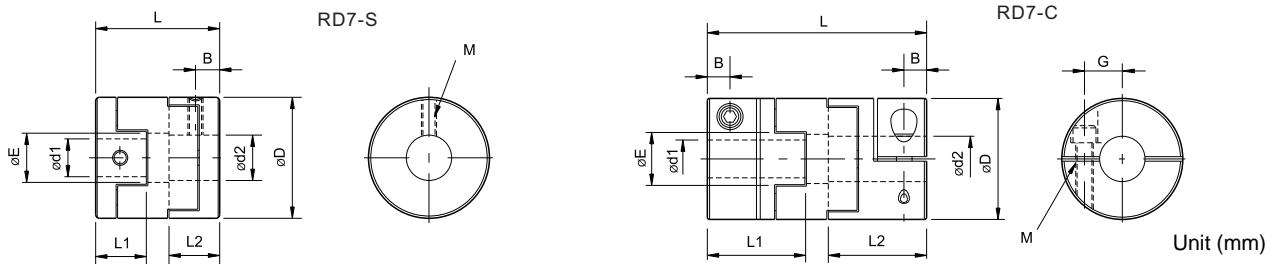

Model	d1·d2		D	L1 · L2	L	E	B	G	M	Tightening Torque(N.m)
	Min	Max								
RD7-16S	3	6.35	16	7	18	7	3.5	-	M3	0.7
RD7-20S	4	8	20	9	23	9	4.5	-	M4	1.7
RD7-25S	5	10	25	11	28	11	5.5	-	M5	4
RD7-32S	8	14	32	13	33	14.5	6.5	-	M6	7
RD7-40S	10	16	40	14	32	17	7	-	M6	7
RD7-50S	14	20	50	17	38	23	8.5	-	M8	15
RD7-16C	4.5	6	16	13	29	7	3	5	M2.5	1
RD7-20C	6	8	20	14	33	9	3	6.5	M2.5	1
RD7-25C	6.35	10	25	17	39	11	3.8	9	M3	1.5
RD7-32C	8	14	32	19	45	14.5	4.5	11	M4	2.5
RD7-40C	12	16	40	23	50	17	7	13	M5	4
RD7-50C	16	20	50	27	58	23	8	16	M6	8

Standard Bore Diameter

Model	Standard Bore Diameter d1.d2(mm)																	
	3	4	4.5	5	6	6.35	7	8	9.525	10	11	12	14	15	16	18	20	25
RD7-16S	●	●	●	●	●	●	●	●										
RD7-20S		●	●	●	●	●	●	●										
RD7-25S				●	●	●	●	●	●									
RD7-32S							●	●	●	●	●	●	●					
RD7-40S									●	●	●	●	●	●	●			
RD7-50S													●	●	●	●	●	
RD7-16C			●	●	●													
RD7-20C					●	●	●	●										
RD7-25C						●	●	●	●	●								
RD7-32C							●	●	●	●	●	●	●					
RD7-40C											●	●	●	●	●			
RD7-50C														●	●	●	●	

Ordering Information

RD7- 20 - 6 x 8 - L(23) Length
 Outer Diameter Bore Diameter:d1-d2
 S: Set Screw Type
 C: Clamp Type